

CASA ARCA

Vivienda Del Habitante

Playa Del Carmen

MEXICO

60 LUXURIOUS SUITES
6 TYPOLOGIES
7 LEVELS

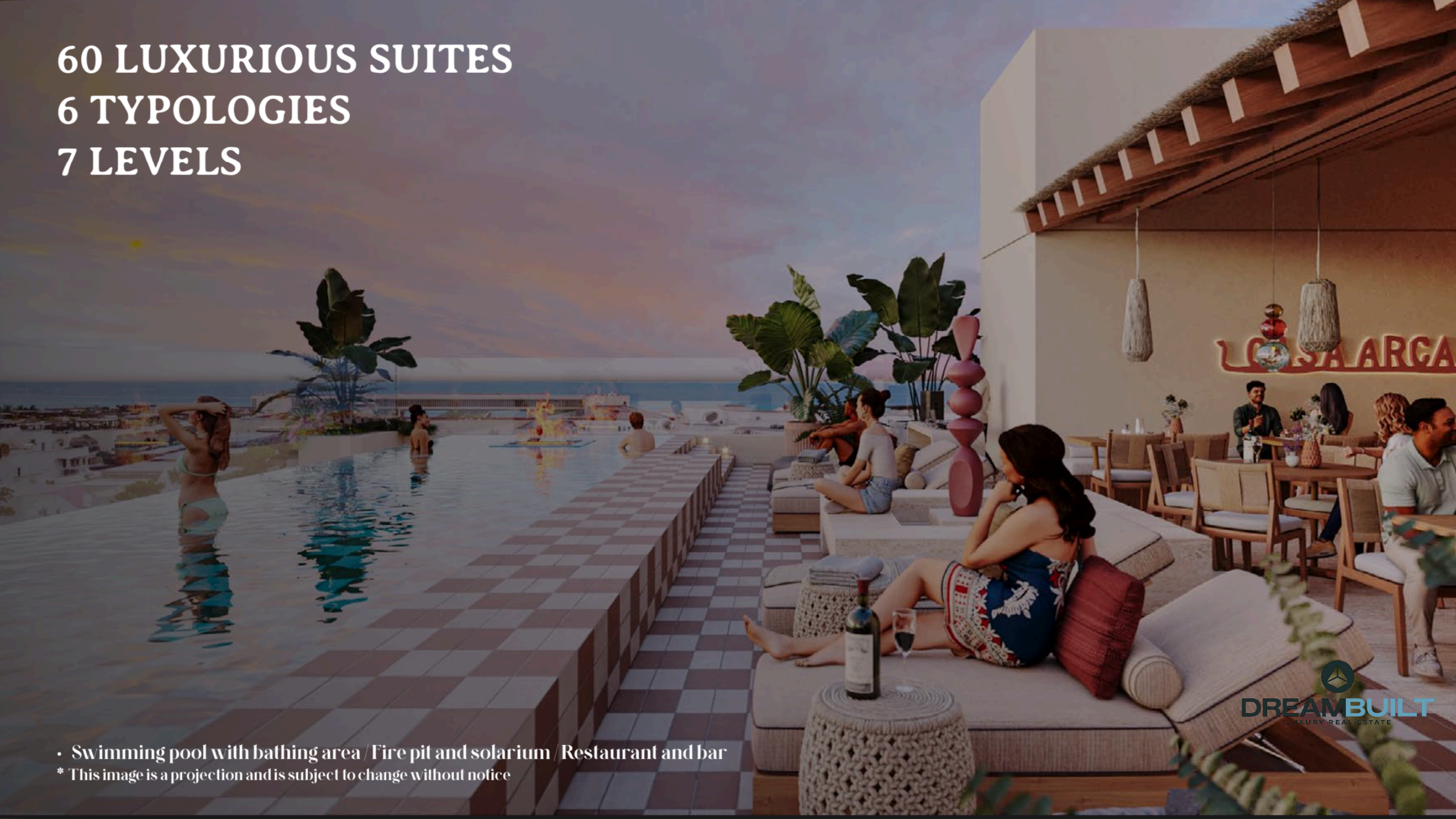

• Swimming pool with bathing area / Fire pit and solarium / Restaurant and bar

* This image is a projection and is subject to change without notice

EXECUTIVE SUITE

• Four exteriors with balcony on each floor / Kitchenette / Living area

* This image is a projection and is subject to change without notice

EXECUTIVE SUITE
AREA: 23.75 M2

ROI: 8.1



Queen-size bed



Kitchenette with glass-ceramic
hob, microwave, stainless steel
sink and minibar

Living and
working room



The image shows a bright, modern bedroom. On the left, a light wood desk with a curved front holds a lamp with a textured orange base and a white shade. A mirror and some books are also on the desk. In the center, a bed with white linens and a patterned pillow is positioned against a curved wall with a yellow grid pattern. To the right, a wooden nightstand is visible. The room has a warm, minimalist aesthetic with light wood and neutral tones.

PANORAMIC SUITE

• Four exteriors with balcony on each floor / Kitchenette / Living area

* This image is a projection and is subject to change without notice

PANORAMIC SUITE

AREA: 25.17 M2

ROI: 7.3



Kitchenette with glass-ceramic
hob, microwave, stainless steel
sink and minibar

Living and
working room

Second floor with
large 9 m² balcony

Queen-size bed

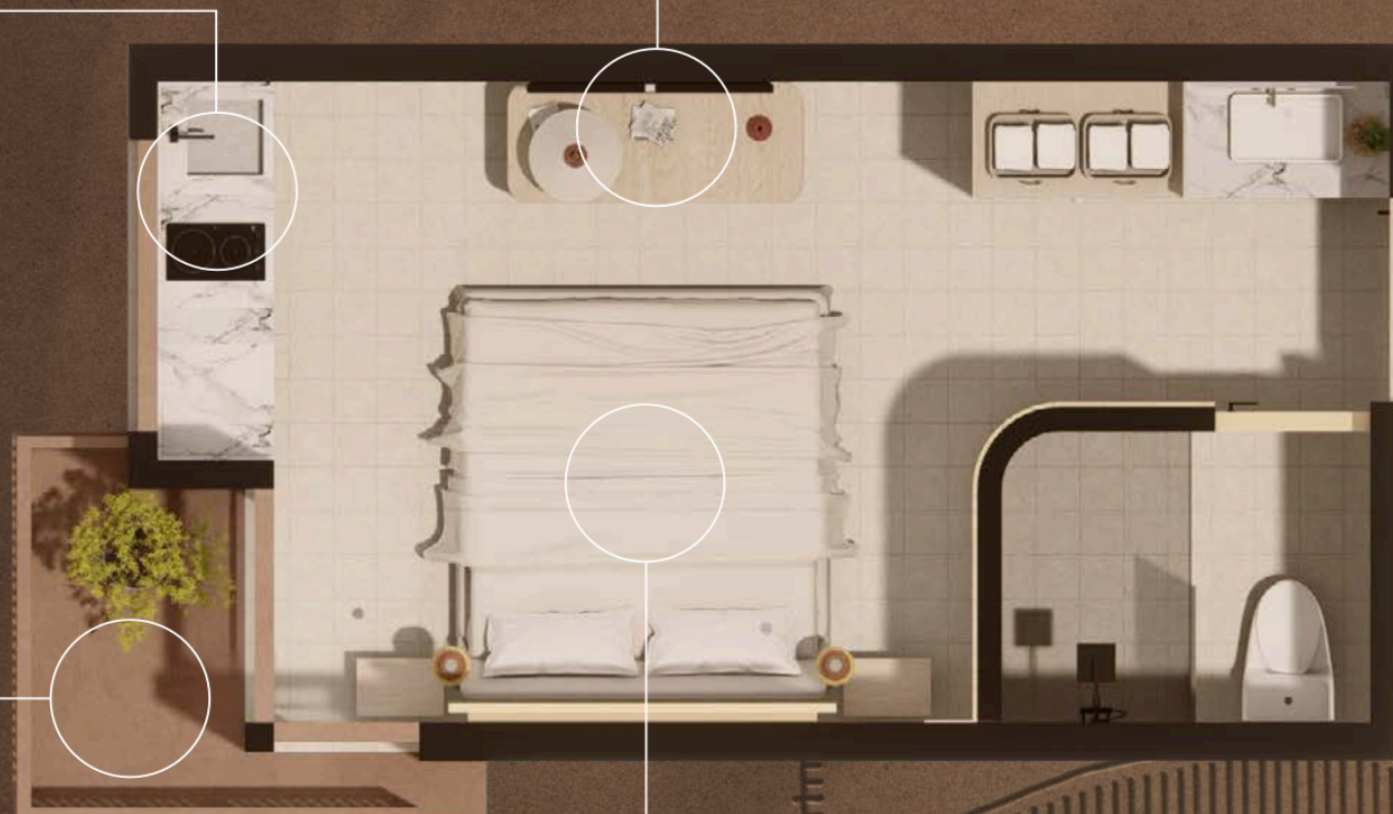



MASTER SUITE

• Four exteriors with balcony on each floor / Kitchenette / Living area

* This image is a projection and is subject to change without notice

MASTER SUITE
AREA: 31.44 M2

ROI: 7.3



Queen size bed

Living and
working room

2 Units with balcony
on each floor

Kitchenette with glass-
ceramic hob, microwave,
stainless steel sink and
minibar

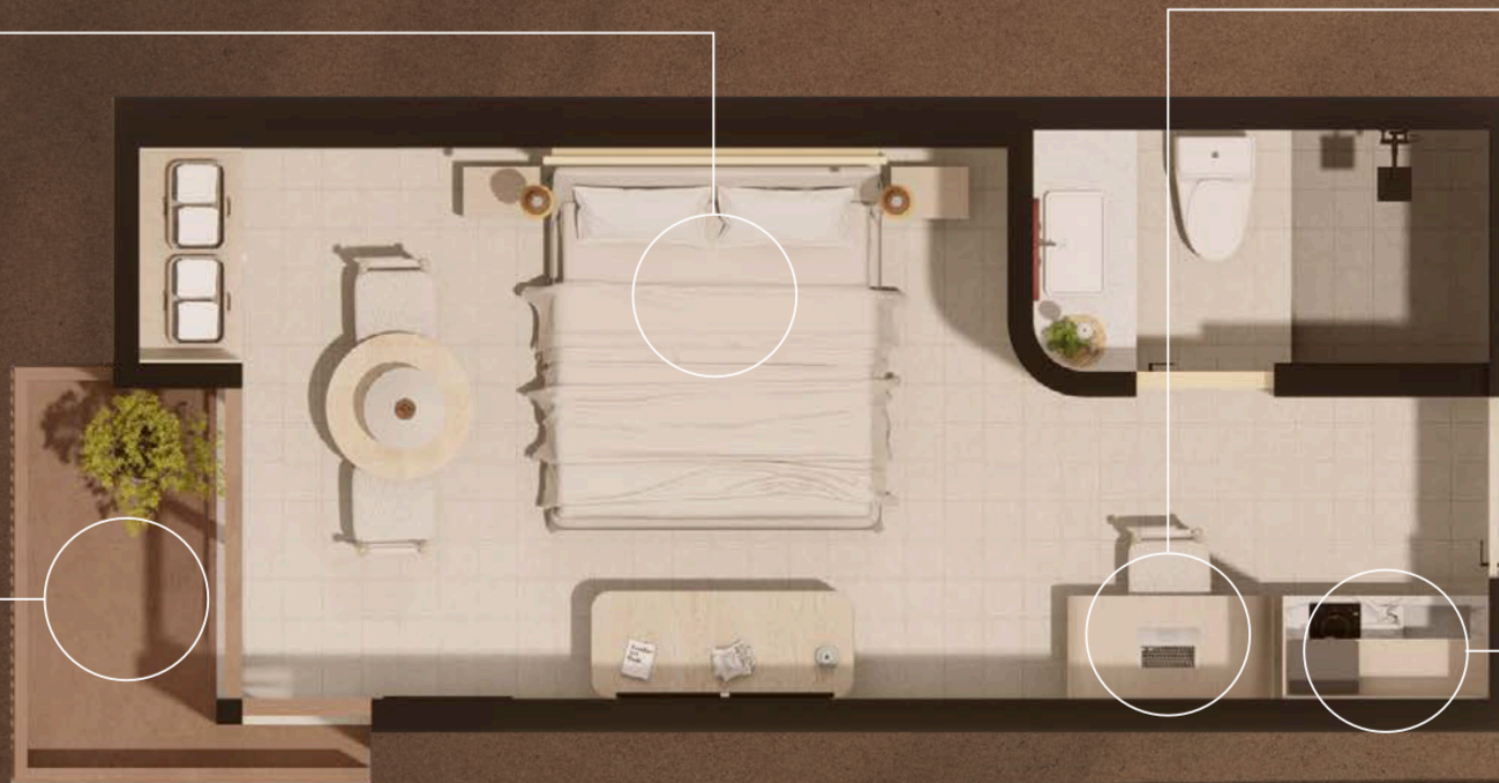



ROYAL SUITE

• 2 Exteriors with balcony / Sitting area / Dining area / Kitchenette / Bathtub

* This image is a projection and is subject to change without notice

ROYAL SUITE
AREA: 47.50 M2

ROI: 7.7



Work area

Double sink

King-size bed

Kitchenette with glass-ceramic
hob, microwave, stainless steel
sink and minibar

Separate shower cubicle
with rain shower head

Hydromassage bathtub



The image shows a spacious, modern interior of a Presidential Suite. The room is characterized by warm, earthy tones and natural materials. In the foreground, there is a dining area with a round wooden table and four chairs with light-colored upholstery. A large, textured, cone-shaped pendant light hangs above the table. To the left, a kitchen area is visible with a wooden countertop and shelves. In the center, a living area features a light-colored sofa and a low, round coffee table with decorative items. Two armchairs with dark cushions are positioned near a large floor-to-ceiling window on the right. The window provides a view of a balcony where a person in a red dress is standing. In the background, a bedroom with a bed and patterned pillows is visible. The overall atmosphere is bright and airy, with soft lighting and a clean, minimalist design.

PRESIDENTIAL SUITE

• 2Exteriors with balcony / Living room / Dining room / Kitchen / Bathroom

* This image is a projection and is subject to change without prior notice

PRESIDENTIAL SUITE
AREA: 56.88 M2

ROI: 7.6

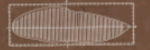

Spacious living
area with living and
dining room

Living and working room

Kitchenette with glass-ceramic
grill, microwave, stainless steel
sink and minibar

Two balconies

King size bed

Hydromassage bathtub



